

*DENOTES CONTINUOUS SUPPORT STRUCTURE NOT BY KALWALL INSTALLERS
 (* DENOTES ADJUSTMENT SHIMS TO BE SUPPLIED BY KALWALL INSTALLER
 TO ACCOMMODATE SECONDARY STEEL TOLERANCES, ENGINEER TO ADVISE TOLERANCES.

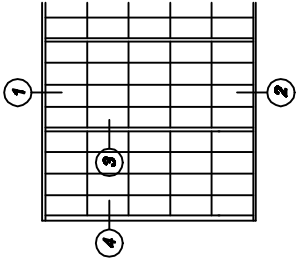

3

KEY ELEVATION
[PORTRAIT APPLICATION]

2" (50mm)
wall batten.

4

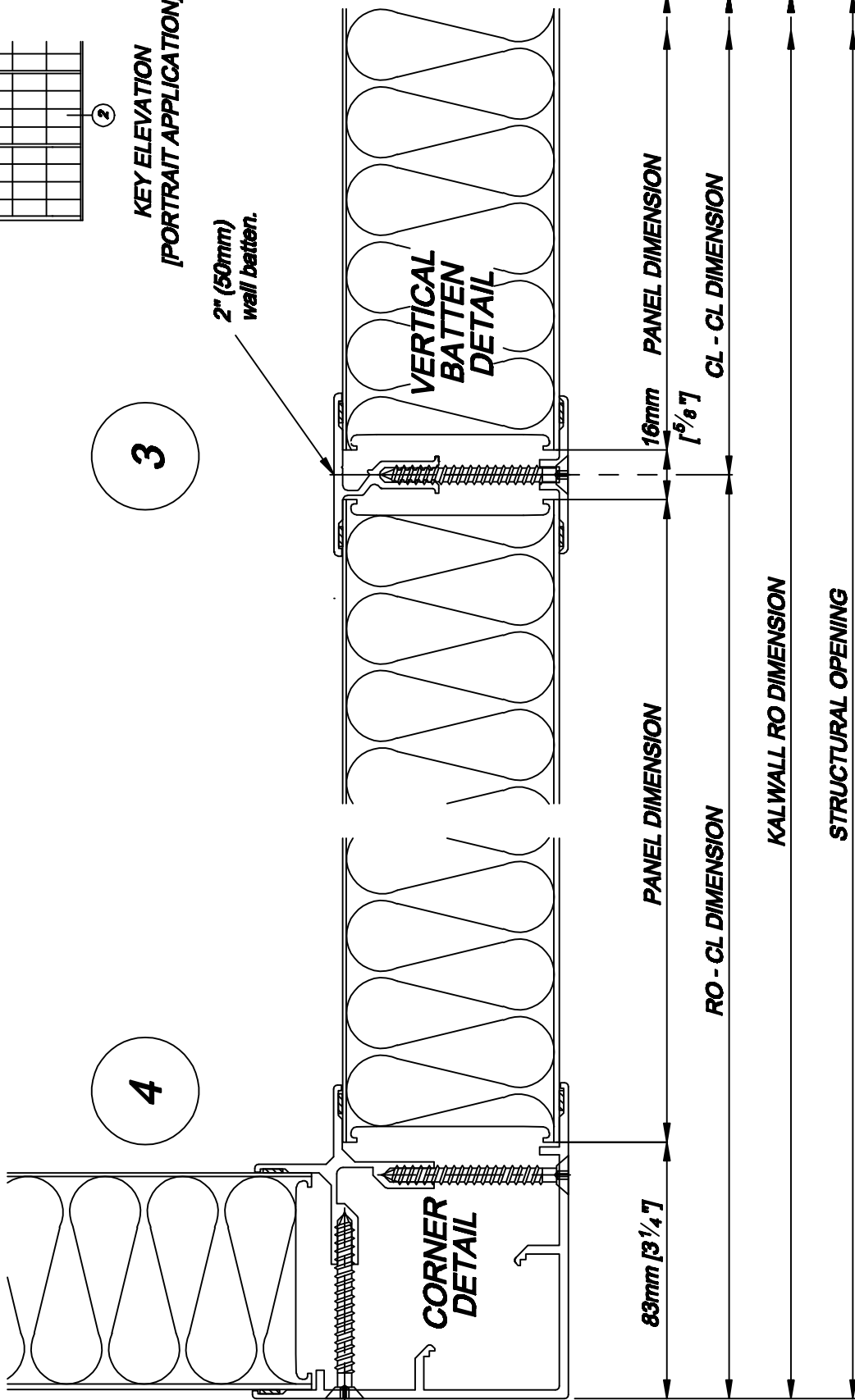

**KALWALL STANDARD CORNER & VERTICAL BATTEN [2"]
 THERMALLY BROKEN WALL PANEL DETAILS**

Stokes Systems Ltd. 1, Banstead road, Purley, Surrey. CR6 3EB
 Tel: 020 8990 7067 Fax: 020 8990 5707 Email: design@stokes.co.uk

This drawing is copyright and may not be reproduced in whole or in part without written consent of Stokes Systems Limited.

STOKES
 STOKES SYSTEMS LTD

Detail Ref.

08T-STD/07

| | | | |
|---------|-----------|--------|-----|
| Date. | Jan. 2004 | Rev. | D |
| System. | 08T | Scale. | 1=2 |